













TOLERANCE:
 $\pm 0.05\text{mm}$ UNLESS OTHERWISE
 SPECIFIED

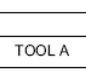

<http://www.CNCdrive.com>

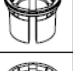
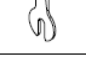
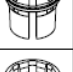
SLEEVES		SHAFT ADAPTER
	2mm Light Sky Blue	
	3mm Orange	BASE 
	3.17mm (1/8 inch) Purple1	
	4mm Gray60	TOP COVER 
	4.76mm (3/16 inch) Yellow1	TOOL A 
	5mm Green1	
	6mm Red1	TOOL B 
	6.35mm (1/4 inch) Snow	
	8mm Blue	

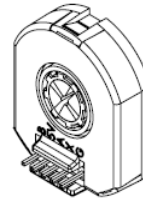
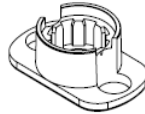
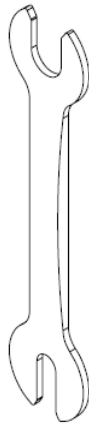

ASSEMBLY

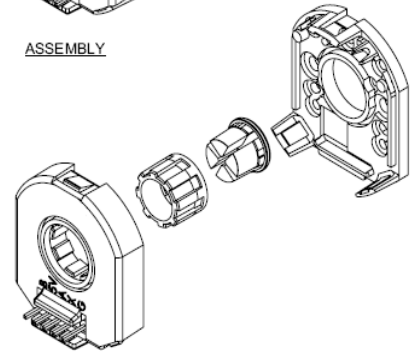

PIN-OUT	
PIN	DESCRIPTION
B	B CHANNEL
5V	+5VDC POWER
A	A CHANNEL
X	INDEX OUTPUT
G	GROUND
MATING CONNECTOR AMP 3-640441-5	

Encoder Pak comes with all items shown: all Sleeve sizes, Shaft Adapter, Base, Top Cover, Tool A, Tool B, Index Pulse, and 16 Resolution Dip Switch.

Sleeve Sizes
sleeve adapters for bore sizes:
diameters: 2mm, 3mm, 3.17mm (1/8"), 4mm, 4.76mm (3/16"), 5mm, 6mm, 6.35mm (1/4"), 8mm.

Operational Specs
3.6 Vdc-5.5Vdc
Temp Range: -40 ~ +100 C

Resolution Options (PPR)

All resolutions stated are before quadrature decoding (example: 1000PPR x 4 = 4000 counts).

Resolutions of AMT103 VersaPak = 48, 96, 100, 125, 196, 200, 250, 256, 384, 400, 500, 512, 800, 1000, 1024, 2048.

Max RPM	Resolutions
7500	2048, 1000, 800, 384 (plus res. from 15k and 30k RPM)
15000	1024, 500, 400, 192 (plus res. from 30k RPM)
30000	512, 250, 200, 96; 256, 125, 100, 48

Mounting Hole Options (see dim drawing for layout)

- 2 each M1.6 holes on 16mm (.63") bolt circle
- 2 each #4 holes on 19.05 (.75") bolt circle
- 2 each M1.6 or M2 holes on 20mm (.787") bolt circle
- 3 each M1.6 or M2 holes on 20.9mm (.823") bolt circle
- 3 each M1.6 or M2 holes on 22mm (.866") bolt circle
- 4 each M1.6 or M2 holes on 25.4mm (1") bolt circle

Note: If the magnet field is above 5 Gauss measured 2mm above the mounting surface for the encoder, the index may not function properly.



Felbontás választása a mikrokapcsolók segítségével:

0 = On, 1 = Off

Resolution (PPR)	Maximum RPM	4	3	2	1
2048	7500	1	1	1	1
1000	7500	1	1	1	0
800	7500	1	1	0	1
384	7500	1	1	0	0
1024	15000	1	0	1	1
500	15000	1	0	1	0
400	15000	1	0	0	1
192	15000	1	0	0	0
512	30000	0	1	1	1
250	30000	0	1	1	0
200	30000	0	1	0	1
96	30000	0	1	0	0
256	30000	0	0	1	1
125	30000	0	0	1	0
100	30000	0	0	0	1
48	30000	0	0	0	0

DIP switch:

Example setting: 500 **ON**

(on) 0 1 (off)

